



eSHADOWALL™ WALL SYSTEM

Achieve superior building energy efficiency through this sustainably designed wall system.

Anticipated changes to energy codes, including ASHRAE Standard 90.1 and LEED v4, are prompting the need for higher-efficiency building solutions. The state-of-the-art eShadowall™ wall system, offered by Butler Manufacturing™, addresses the demand for superior energy performance while also delivering an architecturally pleasing exterior.

Add life cycle cost savings to building projects where energy efficiency is a chief concern. Energy efficiency and a beautiful building can be affordable.

UNIQUE DESIGN DELIVERS FOR LIFE CYCLE SAVINGS

Through the patented eShadowall™ wall system, thermal spacer blocks are field-applied to the panel at the structural fastening locations. This reduces thermal short circuits, where insulation is compressed, while simultaneously creating more depth for thicker layers of insulation. An effective R-value of up to 21.3 (tested U-factor to .048) is achieved using the thermal spacer blocks and fiberglass insulation with a vapor barrier. Thermal values are tested and validated by using the accredited Guarded Hot Box testing lab at the Butler® Research and Development Center.



TESTED U-FACTOR/R-VALUE CHART

The chart below details the tested U-factors and associated R-values that can be achieved with the eShadowall system.

Wall Assembly	Tested U-Factor	Effective R-Values
Standard Shadowall R-19	.075	13.3
eShadowall R-16 Assembly	.059	16.9
eShadowall R-19 Assembly	.056	17.9
eShadowall R-25 Assembly	.048	21.3

MEETING AND EXCEEDING ENERGY CODES

The eShadowall system offers a cost-effective solution for fulfilling the International Energy Conservation Code and ASHRAE Standard 90.1, which serves as the foundation of many state energy code requirements in the eight climate zones across the United States.

A VISUALLY STRIKING APPEARANCE

Uniform lines are created through 36-inch wide panels with 1 7/16-inch deep corrugations. Fasteners are semi-concealed in the corrugation to further enhance the appearance of the eShadowall system.

GREATER ENERGY EFFICIENCY THROUGH FEWER FASTENERS

The eShadowall system requires up to 33 percent fewer fasteners than most wall panel systems. In addition to lowering overall installation costs, this system also minimizes heat loss at fastener locations using thermal spacer blocks for enhanced thermal performance.

FAST AND ACCURATE INSTALLATION

The 26-gauge panels and structural members can be factory-punched for greater speed and precision in the installation process. The thermal spacer blocks are field-applied with a peel and stick adhesive until the panel is installed with a fastener. Accurate installation leads to long-term building performance and added life cycle costing.

A PREMIER WARRANTY

The eShadowall system features the high-quality Butler-Cote™ premium finish. Made with a 70 percent Kynar 500® or Hylar 5000® resin, this incredibly durable fluoropolymer coating carries a 25-year finish warranty against blistering, peeling, cracking or chipping of the paint finish.

eSHADOWWALL™ WALL SYSTEM

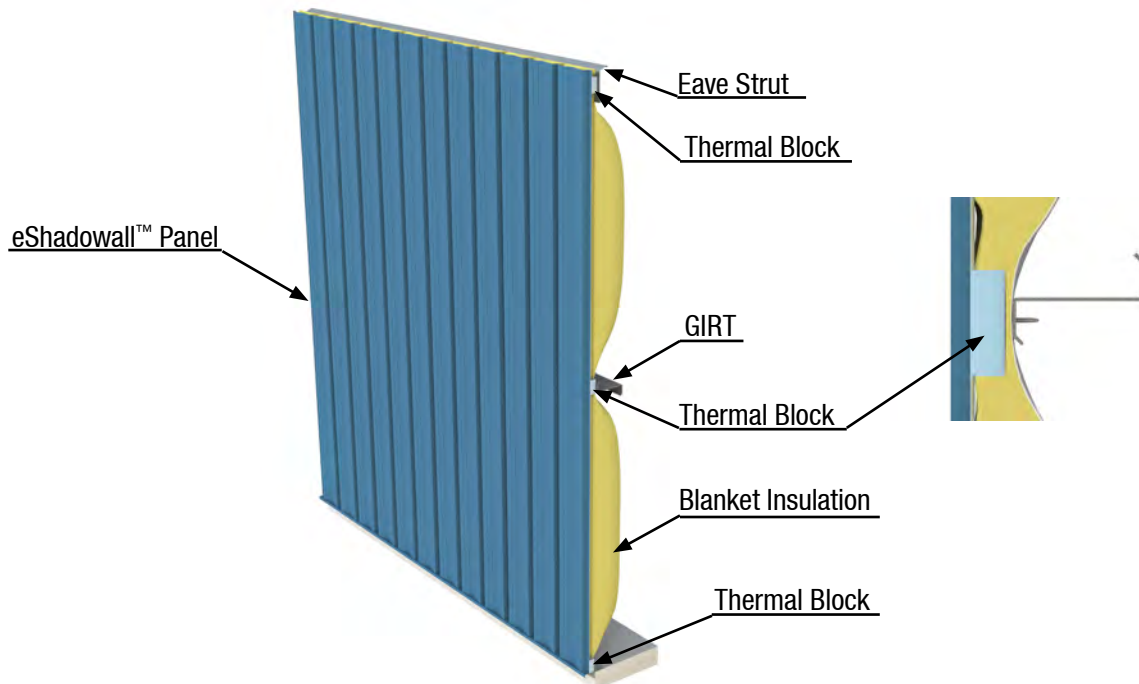

KEY BENEFITS

- ✓ Energy efficiency is gained through the unique assembly design of the eShadowwall panel, thermal spacer blocks and fiberglass blanket insulation.
- ✓ Exclusive factory-punched panels allow for speedy installation and ensure long-term building performance.
- ✓ Up to 33 percent fewer fasteners than most wall panel systems, reducing installation costs and preventing heat loss.
- ✓ Semi-concealed fasteners and deep corrugation further enhance panel appearance.
- ✓ High-performing Butler-Cote™ 25-year fluoropolymer finish resists chalking and fading.
- ✓ Versatile system can be used with Butler roof and structural systems for all building types.

BUTLER OFFERS YOU MORE

Butler Builders provide complete construction services with single-source responsibility

- Reputable professionals with extensive knowledge of local building codes

Maximize your building's performance with a complete Butler® system solution

- Innovative structural, wall, and roof systems
- Precision engineered for seamless integration



Butler Manufacturing
Kansas City, MO
816-968-3000

Butler Buildings Canada
Burlington, ON, Canada
905-332-7786

www.butlermfg.com



Butler® building products are constantly being improved; therefore, the information contained herein is subject to change without notice. Before finalizing project details, contact your nearest Butler Builder® or Butler Manufacturing™ for the latest information. Kynar 500® is a registered trademark of Arkema. Hylar 5000® is a registered trademark of Solvay Solexis. The USGBC logo is a registered trademark owned by the U.S. Green Building Council and is used by permission. IAS is a subsidiary company of the International Code Council. The ENERGY STAR name and the ENERGY STAR symbol are registered trademarks of the United States Environmental Protection Agency.

© 2015 BlueScope Buildings North America, Inc. All rights reserved. Butler Manufacturing™ is a division of BlueScope Buildings North America, Inc. Find your independent Butler Builder® at www.butlerbuilder.com.
Form No. 5515 4/15